



# wej-it®

## Estimating Guide

Bolt Size	Drill Diameter	Hole Depth	Anchors/Tube	
			1.7 oz Cartridge	22 oz Cartridge
1/4	5/16	1-3/4	75	900
5/16	7/16	2-3/4	18	230
3/8	1/2	3-1/4	15	180
1/2	5/8	4-1/8	10	60
5/8	7/8	6-1/4	3	38
3/4	1	7-1/2	2	20
1	1-1/2	9-1/2	•	4

Number of anchors per cartridge is based on exact volumetric calculations. No allowance has been made for waste.

## Order Information

Mfg. Number			Bolt Size	Dimensions (in)
Carbon Steel	Stainless Steel			
Zinc Plated	(303)	(316)		
PS2-14	PSS-14	PS6-14	1/4	5/16 X 1-9/16
PS2-56	PSS-56	PS6-56	5/16	7/16 X 2-3/8
PS2-38	PSS-38	PS6-38	3/8	1/2 X 2-3/4
PS2-12	PSS-12	PS6-12	1/2	5/8 X 3-11/16
PS2-58	PSS-58	PS6-58	5/8	7/8 X 5-3/4
PS2-34	PSS-34	PS6-34	3/4	1 X 6-1/2
PS2-1	PSS-1	PS6-1	1	1-1/2 X 8-1/2

## ANSI B94 Standard

Use solid, carbide-tipped drill bits manufactured to ANSI B94 with standard tolerance on the tip end as follows:

Diameter	Minimum Inches	Maximum Inches
1/4	0.260	0.268
5/16	0.327	0.335
3/8	0.390	0.398
1/2	0.520	0.530
5/8	0.650	0.660
3/4	0.775	0.787
7/8	0.905	0.917
1	1.030	1.042
1-1/8	1.160	1.175
1-1/4	1.285	1.300
1-1/2	1.535	1.550

### Note:

All test data derived from independent testing laboratories as indicated. Testing criteria, methods, and equipment differ between sources and, therefore, definitive performance data and holding values should be obtained by the user through laboratory or jobsite testing, utilizing design engineer specified testing criteria, methods, and equipment.

## Installation Instructions

1. Select the proper size drill bit from the estimating guide. Drill the hole perpendicular to the work surface.\* To assure full holding power, do not ream the hole or allow the drill to wobble.
2. Clean hole with compressed air and a nylon brush.\* Dust and debris left in hole will significantly reduce the holding capacity of the anchor.
3. Inject Inject-TITE® Two-Part Structural Epoxy into hole to approximately 1/3 to half full.
4. Choose a bolt equal in length to the thread depth plus the material depth. Thread bolt into POWER-Sert® anchor so that offset is equal to the thickness of material to be fastened. Insert POWER-Sert® anchor into hole to shoulder with slight twisting motion.
5. Drive anchor home with several sharp hammer blows to the head of the nut.
6. Allow epoxy to cure prior to applying maximum load.

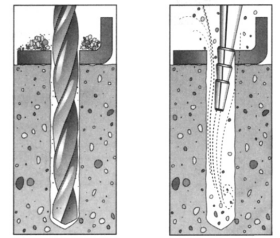

1

2

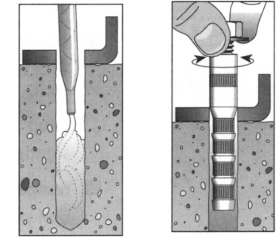

3

4

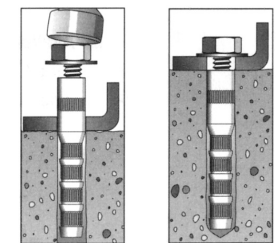

5

6

\* Always wear safety glasses. Follow the drill manufacturer's safety instructions. Use only solid carbide-tipped drill bits meeting ANSI B94 diameter standards.

## VISIT US AT:

# [www.seaport-marine.com](http://www.seaport-marine.com)

or

## E-MAIL TO:

# [sales@seaport-marine.com](mailto:sales@seaport-marine.com)